



# Adams

Collection: The Wellington Collection Floor Plan: Adams

Square Feet: 1,523 (m.o.l.) Bedrooms: 3 Full Bathrooms: 2 Garage: 2 Car



Elevation A



Elevation B



Elevation C

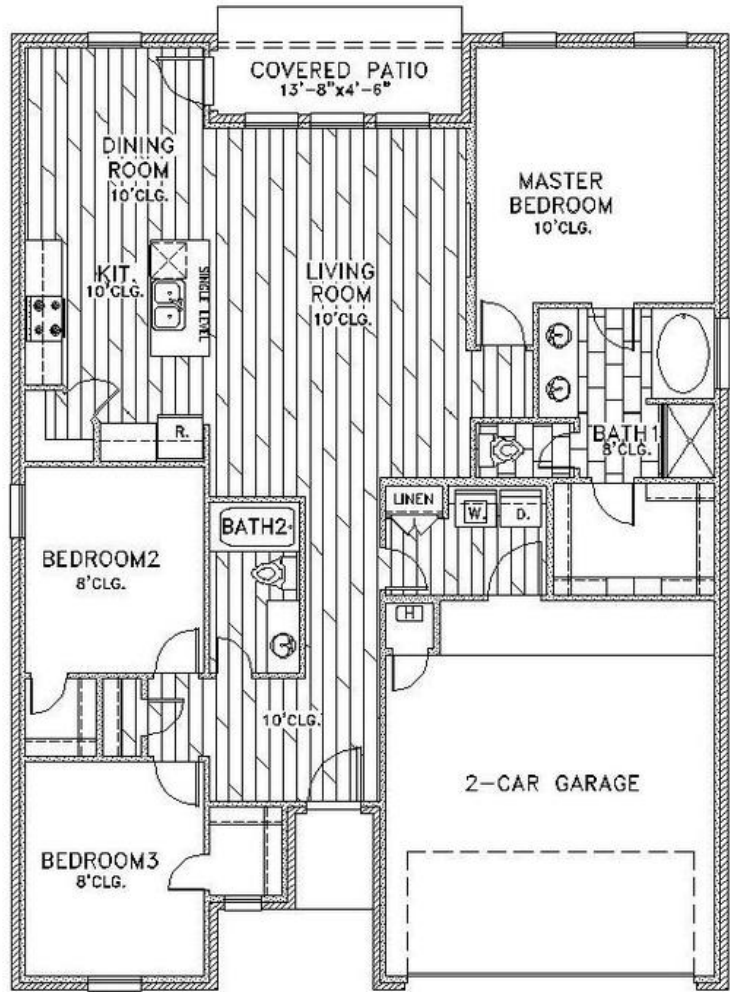

---

Floor plans' specifications, included features, options and elevations are subject to change.





## Included Features

Collection: The Wellington Collection Floor Plan: Adams

Square Feet: 1,523 (m.o.l.) Bedrooms: 3 Full Bathrooms: 2 Garage: 2 Car

### Bathroom

Bathroom hardware (stainless steel, chrome or black)  
Elongated toilets in bathrooms  
Garden tub and separate shower with glass doors and acrylic insert in primary bath

Fiberglass shower/tub combo in Hall bathroom  
3 cm granite vanity tops with ceramic undermount bowls

### Interior Finishes

Pull-down attic access in garage (in single story plan)  
Full Blinds  
Insulated entry door (panel style may vary)  
Ceramic tile floor in entry, kitchen, dining room, bathrooms and utility room  
Wall-to-wall plush cut carpet with 1/2" 6lb pad  
Raised 10' ceiling in living areas (in single story plan)  
Ceiling fans in living room and primary bedroom

Box rated for ceiling fan in all other bedrooms  
Energy efficient LED lighting  
Paint grade baseboards  
Orange peel texture walls  
Gas log fireplace or modern style electric fireplace  
Bullnose corners in common areas (varies per plan)

### Energy-efficiency

97% efficient tankless water heater  
Eave roof ventilation  
Polycel caulking around windows, doors and joints  
Insulated and mastic sealed A/C ducts  
HERS Index Energy Efficiency Rating (varies per plan & home permit date)  
Gas heating 96% high efficiency furnace

R-44 Blown-in insulation in attic and RR-15 in exterior walls  
Low-e Thermalpane tilt-in vinyl windows with screen  
R-19 Batt insulation in sloped ceiling  
97% efficient gas tankless water heater (homes permitted after 4/15/19)  
Perimeter slab insulation  
House wrap with moisture barrier

### Construction / Plumbing / Electric / Mechanical

Exterior 2 x 4 stud-grade lumber walls  
Protective ground fault interrupter circuits  
Electric dryer connection in utility room  
16 SEER electrical central air conditioning  
Fire rated sheetrock wall & ceiling

Uponor AquaPEX tubing for water lines  
Category 5 structured wiring  
Copper electrical wiring\*  
Stone corner on front of home per plan  
RG6 quad shield cable wiring (minimum of 4 cable outlets)

### Safety

ToughRock 45 Gypsum Board walls and ceilings (except Barrel Ceilings)  
Oriented Strand Board (OSB) exterior walls  
Anchor bolts that secure perimeter walls to foundation

Tornado Straps that secure perimeter walls to rafters  
Installed smoke & carbon monoxide detectors

### Exterior Finishes

Two-car garage with insulated, wind-resistant steel panels, and garage door opener with two remote control openers  
Concrete patio (varies per plan)  
Guttering over AC pad and entry (varies per plan)  
Three exterior waterproof electrical outlets  
Landscaping package

Semi-gloss exterior paint  
Brick exterior with brick ledge and siding on back  
Two exterior frost proof water spigots  
Brick mailbox with cast stone address block (may vary due to location of property)

### Warranties

Manufacturer's limited lifetime shingle warranty  
Termite company's warranty  
RWC New Home limited 10-year warranty  
Brick company's limited 100-year warranty

Manufacturer's limited appliance warranty  
Manufacturer's limited heating & cooling units warranty  
Builder's limited one-year warranty

### Kitchen

Water line for refrigerator icemaker  
1-hole kitchen faucet  
Stainless steel gas freestanding range, over the range microwave and dishwasher (homes permitted after 4/15/19)

USB outlet in kitchen  
3 cm granite or quartz kitchen countertops with subway tile backsplash

Buyer's Initials \_\_\_\_\_ Buyer's Initials \_\_\_\_\_ Seller's or its Representative's Initials \_\_\_\_\_

*Due to constant updates and revisions of our plans, features in your home may slightly vary from the designs' features, by floor plans or products used.*

